

Honeywell

Honeywell Information Systems Italia

**LOW COST SERIAL PRINTER
CATALOGO PARTI DI RICAMBIO
ILLUSTRATED PARTS CATALOG**

71011348 - 100

MARZO - MARCH 1977

COPYRIGHT © 1977, HONEYWELL INFORMATION SYSTEMS ITALIA

Le informazioni contenute in questo volume sono di esclusiva proprietà della Honeywell Information Systems Italia eccetto dove diversamente indicato e non possono essere riprodotte nè per intero nè in parte senza l'esplicita autorizzazione scritta della Honeywell Information Systems Italia. La distribuzione di questo materiale all'esterno della Honeywell Systems Italia può avvenire solo se autorizzata.

COPYRIGHT © 1977, HONEYWELL INFORMATION SYSTEMS ITALIA

The information contained herein, unless specified otherwise is the exclusive property of Honeywell Information Systems Italia and shall not be disclosed or reproduced in whole or in part without explicit written approval from the company. Distribution of this material outside the company may occur only if authorized.

Sezione Assistenza Tecnica - Via Nuvolone, 44 Milano
Stampato in Italia
Tutti i diritti riservati

F.E. Headquarters - Via Nuvolone, 44 Milan
Printed in Italy
All Rights Reserved

REGISTRAZIONE DELLE REVISIONI/RECORD OF REVISIONS			
DATA DATE	N. MODIFICA CHANGE N.	NOTE/PAGINE AGGIORNATE NOTES/PAGES AFFECTED	FIRMA SIGNATURE
Rev. 0 6/75		I Edizione - 1st Edition 71011348-001	<i>Spina</i>
Rev. 0 3/77		II Edizione - 2rd Edition 71011348-100	<i>Spina</i>

INDICE

Sezione	Pagina	Coord.
IX CATALOGO PARTI DI RICAMBIO	9-1	A01
9.1 Introduzione	9-1	A01
9.1.1 Figure dei gruppi degli assiemi	9-1	A01
9.1.2 Tavole liste parti	9-1	A01
9.1.2.1 Colonna riferimento	9-1	A01
9.1.2.2 Description	9-2	A02
9.1.2.3 Part number	9-2	A02
9.1.2.4 Use on code	9-2	A02
9.1.2.5 Ref. fig. (reference figure)	9-2	A02
9.1.2.6 Microfiche coordinate	9-2	A02
Tavola di riferimento	9-5	A05
Tavola 9-1 Assieme Meccanica	9-6	A06
Figura 9-1 Assieme Meccanica	9-7	A07
Tavola 9-2 Assieme Meccanica	9-8	A08
Figura 9-2 Assieme Meccanica	9-9	A09
Tavola 9-3 Assieme Testina e Carrello	9-10	A10
Figura 9-3 Assieme Testina e Carrello	9-11	A11
Tavola 9-4 Assieme Supporto Motore	9-12	A12
Figura 9-4 Assieme Supporto Motore	9-13	A13
Tavola 9-5 Assieme Alimentatore	9-14	B01
Figura 9-5 Assieme Alimentatore	9-15	B02
Tavola 9-6 Pacco Logico	9-16	B03
Figura 9-6 Pacco Logico	9-17	B04
Tavola 9-7 Chips della Piastra CPU	9-18/9-19.1	B05/B07
Figura 9-7 Chips della Piastra CPU	9-19/9-19.2	B06/B08
Tavola 9-7.1 Chips della Piastra CPO	9-19.3	B09
Figura 9-7.1 Chips della Piastra CPO	9-19.4	B10
Tavola 9-8 Copertura e Tastiera	9-20	B11
Figura 9-8 Copertura e Tastiera	9-21	B12
Tavola 9-9 Pannello Operatore	9-22	B13
Figura 9-9 Pannello Operatore	9-23	B14
Tavola 9-10 Opzione AFF (Meccanica)	9-24	C01
Figura 9-10 Opzione AFF (Meccanica)	9-25	C02
Tavola 9-11 Opzione VFU	9-26	C03
Figura 9-11 Opzione VFU	9-27/9-28	C04
Repertorio Numerico	9-29	D01
Repertorio Numerico	9-30	D02
Repertorio Numerico	9-31	D03

INDEX

Section	Page	Coord.
IX ILLUSTRATED PARTS CATALOG	9-3	A03
9.1 Introduction	9-3	A03
9.1.1 Group assembly figures	9-3	A03
9.1.2 Parts list tables	9-3	A03
9.1.2.1 Index No. column	9-3	A03
9.1.2.2 Description column	9-4	A04
9.1.2.3 Part number column	9-4	A04
9.1.2.4 Use on code column	9-4	A04
9.1.2.5 Ref. fig. (reference figure) column	9-4	A04
9.1.2.6 Microfiche coordinates column	9-4	A04
Reference table	9-5	A05
Table 9-1 Mechanics Assembly	9-6	A06
Figure 9-1 Mechanics Assembly	9-7	A07
Table 9-2 Mechanics Assembly	9-8	A08
Figure 9-2 Mechanics Assembly	9-9	A09
Table 9-3 Head and Carriage Assembly	9-10	A10
Figure 9-3 Head and Carriage Assembly	9-11	A11
Table 9-4 Motor Holder Assembly	9-12	A12
Figure 9-4 Motor Holder Assembly	9-13	A13
Table 9-5 Power Supply Assembly	9-14	B01
Figure 9-5 Power Supply Assembly	9-15	B02
Table 9-6 Logic Boards	9-16	B03
Figure 9-6 Logic Boards	9-17	B04
Table 9-7 CPU Board chips	9-18/9-19.1	B05/B07
Figure 9-7 CPU Board chips	9-19/9-19.2	B06/B08
Table 9-7.1 CPO Board chips	9-19.3	B09
Figure 9-7.1 CPO Board chips	9-19.4	B10
Table 9-8 Covers and Keyboard Group	9-20	B11
Figure 9-8 Covers and Keyboard Group	9-21	B12
Table 9-9 Operator Panel	9-22	B13
Figure 9-9 Operator Panel	9-23	B14
Table 9-10 Opt. AFF (Mechanism)	9-24	C01
Figure 9-10 Opt. AFF (Mechanism)	9-25	C02
Table 9-11 Opt. VFU	9-26	C03
Figure 9-11 Opt. VFU	9-27/9-28	C04
Numerical Part List	9-29	D01
Numerical Part List	9-30	D02
Numerical Part List	9-31	D03

IX

CATALOGO PARTI DI RICAMBIO

Il Catalogo Parti di Ricambio illustra e descrive assiami e parti in dettaglio della LOW COST SERIAL PRINTER. Questa sezione serve per identificare ed ordinare le parti usate su detta macchina ed illustra le loro relazioni di montaggio e smontaggio.

9.1 INTRODUZIONE

Le figure degli assiami comprendono un'esplosione delle parti complete in ordine di smontaggio. Le parti complete montate, gli assiami principali, i sottoassiami sono illustrati fino al grado richiesto per poter identificare tutti i componenti elencati.

9.1.1 Figure dei gruppi degli assiami

Tutte le figure hanno come titolo il nome dell'assieme o del sottoassieme illustrato.

Ciascuna esplosione illustrata è accompagnata da numeri di riferimento. Questi riferimenti, che si trovano su ciascuna figura, appaiono anche sulla corrispondente tabella che elenca le parti.

Il numero di riferimento cerchiato (es. ○) che si trova sulle figure, indica un assieme.

9.1.2 Tavole liste parti

Queste tavole sono organizzate come segue:

INDEX No	DESCRIPTION	PART-NUMBER	USE ON CODE	REF. FIG.	MICRO-FICHE COORD.
----------	-------------	-------------	-------------	-----------	--------------------

9.1.2.1 Colonna riferimento

I numeri elencati in questa colonna corrispondono ai richiami nelle illustrazioni degli assiami.

Ciascuna tavola e la sua corrispondente illustrazione portano lo stesso numero.

9.1.2.2 Description

Questa colonna comprende una nomenclatura descrittiva per ciascuna parte in modo tale da mostrare la relazione tra ciascun gruppo, sottogruppo o parte e il gruppo principale.

9.1.2.3 Part number

Questa colonna contiene il codice di ciascuna parte elencata nella colonna "Descrizione".

9.1.2.4 Use on code

Questa colonna indica, per mezzo di un codice alfabetico, le differenze di configurazione quando nella tabella sono elencate più configurazioni.

Quando in questa colonna non vi è alcun richiamo, significa che la parte descritta si applica a tutte le eventuali configurazioni.

9.1.2.5 Ref. fig. (reference figure)

Questa colonna indica il numero della figura dell'assieme immediatamente maggiore o minore.

9.1.2.6 Microfiche coordinate

In questa colonna viene indicata la localizzazione della pagina sulle microfiche.

IX

ILLUSTRATED PARTS CATALOG

The Illustrated Parts Catalog (IPC) lists, illustrates and describes assemblies and detail parts of the LOW COST SERIAL PRINTER subsystem. This section is used for identifying and requisitioning parts used in the LOW COST SERIAL PRINTER subsystem and illustrates their assembly and disassembly relationships.

9.1 INTRODUCTION

The group assembly figures comprise a breakdown of the complete article in disassembly order. The completely assembled article, main groups assemblies and subassemblies of the MTCA-1 subsystem are illustrated to the degree required to identify all components listed.

9.1.1 Group assembly figures

All figures are titled with the name of the assembly or subassembly illustrated.

Each illustrated breakdown is accompanied by callout index numbers. The index numbers shown on each figure appear in the corresponding parts list table.

The circled reference number (i.e. ○) on the figures identifies an assembly.

9.1.2 Parts list tables

The parts list tables are organized as follow:

INDEX No	DESCRIPTION	PART - NUMBER	USE ON CODE	REF. FIG.	MICRO-FICHE COORD.
----------	-------------	---------------	-------------	-----------	--------------------

9.1.2.1 Index No. column

The numbers listed in the INDEX No. column correspond to the callouts in the associated group assembly figures. Each parts list and its corresponding figure carry the same number.

9.1.2.2 Description column

The description column contains descriptive nomenclature for each item, arranged to show the relationship of each assembly, subassembly or component part to the top assembly in each table.

9.1.2.3 Part number column

This column contains the part number assigned to each item listed in the description column.

9.1.2.4 Use on code column

The use on code column denotes, by use of alpha coding, configuration differences where more than one configuration is listed in a table. When this column is blank the part described applies to all configurations.

9.1.2.5 Ref. fig. (reference figure) column

This column indicates the figure number of the next higher or lower assembly.

9.1.2.6 Microfiche coordinates column

This column reports the coordinates that enable to locate the page on the microfiche.

TAVOLA DI RIFERIMENTO - REFERENCE TABLE

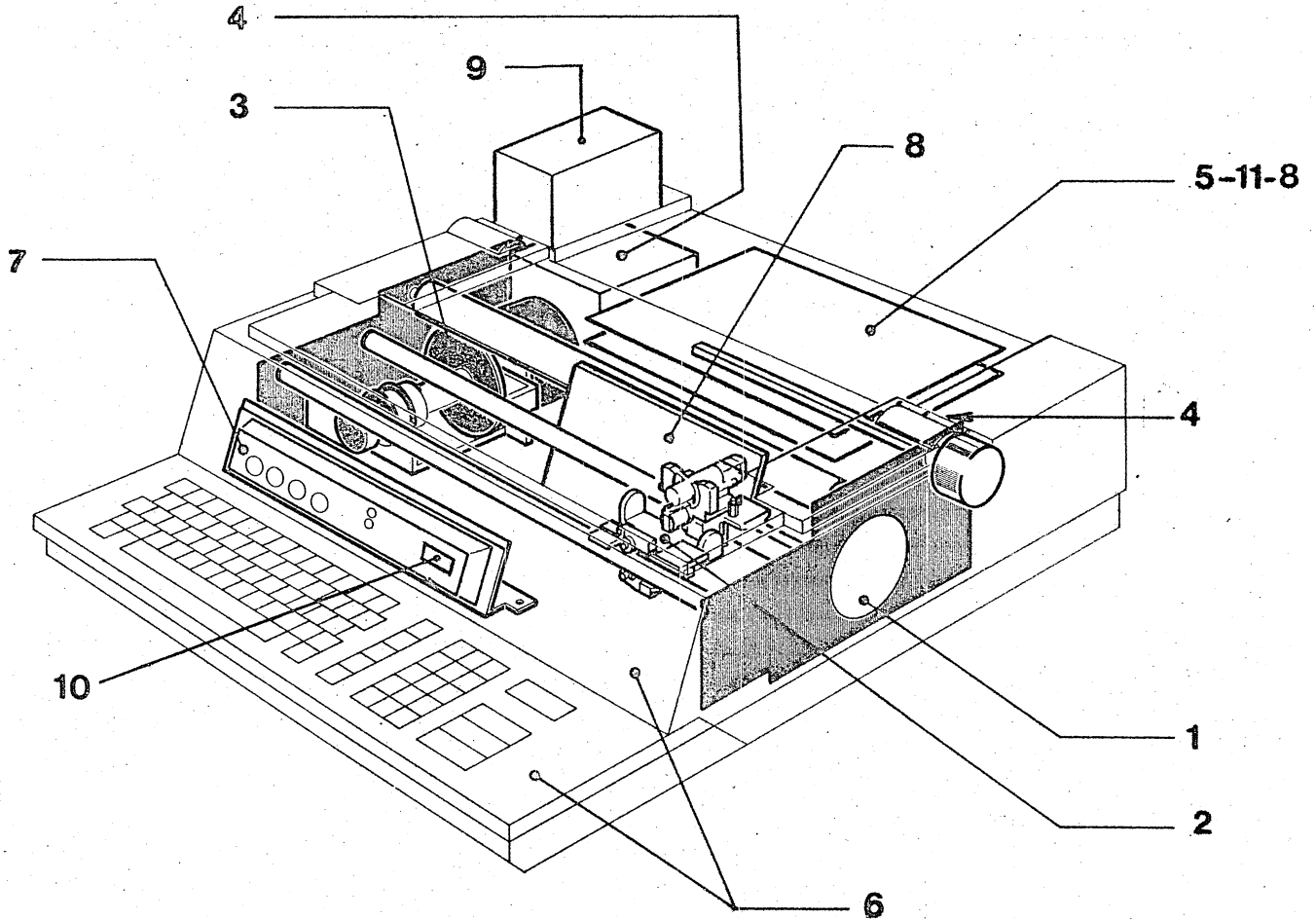

Rif. Item	Descrizione - Description	Pagina Page
1	Assieme Meccanica - Mechanis Assembly	6 to 9
2	Assieme Testina e Carrello - Head and Carriage Assembly	10 - 11
3	Assieme Supporto Motore - Motor Holder Support	12 - 13
4	Assieme Alimentatore - Power Supply Assembly	14 - 15
5	Pacco Logico - Logic boards	16 - 19
6	Coperture e Tastiera - Covers and Keyboard Group	20 - 21
7	Pannello Operatore - Operator Panel	22 - 23
8	Opzione AFF - AFF option	24 - 25
9	VFU option - Opzione VFU	26 - 27
10	Opzione contacolonne - Display option	22 - 23
11	Opzione Loop di corrente - Current Loop option	16 - 19

Tavola 9-1 Assieme Meccanica - Table 9-1 Machanics Assembly

INDEX No	DESCRIPTION	PART - NUMBER	USE ON CODE	REF. FIG.	MICRO-FICHE COORD.
	Mechanics Assembly			9-1	
				9-2	
1	Head Assembly	78117381-002		9.3	
2	Carriage Assembly	78113810-001		9.3	
3	Belt	78203153-001			
4	Retaining Ring	6337309H			
5	Drive Wheel	78115071-001			
6	Driven Wheel	78115070-001			
7	Handle	78114555-001			
8	Flange	78113521-001			
9	Screw M4 x 5	0005041C			
10	Bearing	78203247-036			
11	Screw M4 x 14	6313117E			
12	Flat Washer 4.3 dia	6313104X			
13	Nut M4	6321104W			
14	Shaft	78117117-001			
15	Retaining Ring	6337112C			
16	Guide Bar	78113516-001			
17	Special Washer	78113553-001			
18	Roller	78115238-001			
19	Screw M2 x 10	7454693W			
20	Cartridge Hook	78113820-001			
21	Set Screw	78203182-001			
22	Roller Lever	78113512-001			
23	Adjust Plate	78113511-001			
24	Bumper	78113528-001			
25	Retaining Hub	78113484-001			
26	Drive Pulley	78113517-001			
27	Screw M4 x 18	6313118T			
28	Spring	78113498-002			
29	Actuator	78115442-001			
30	Retaining Ring	6337118W			
31	Plate	78105720-001			
32	Microswitch	78200192-002			



Figura 9-1 Assieme Meccanica - Figure 9-1 Mechanics Assembly

Tavola 9-2 Assieme Meccanica

- Table 9-2 Mechanics Assembly

INDEX No	DESCRIPTION	PART-NUMBER	USE ON CODE	REF. FIG.	MICRO-FICHE COORD.
----------	-------------	-------------	-------------	-----------	--------------------

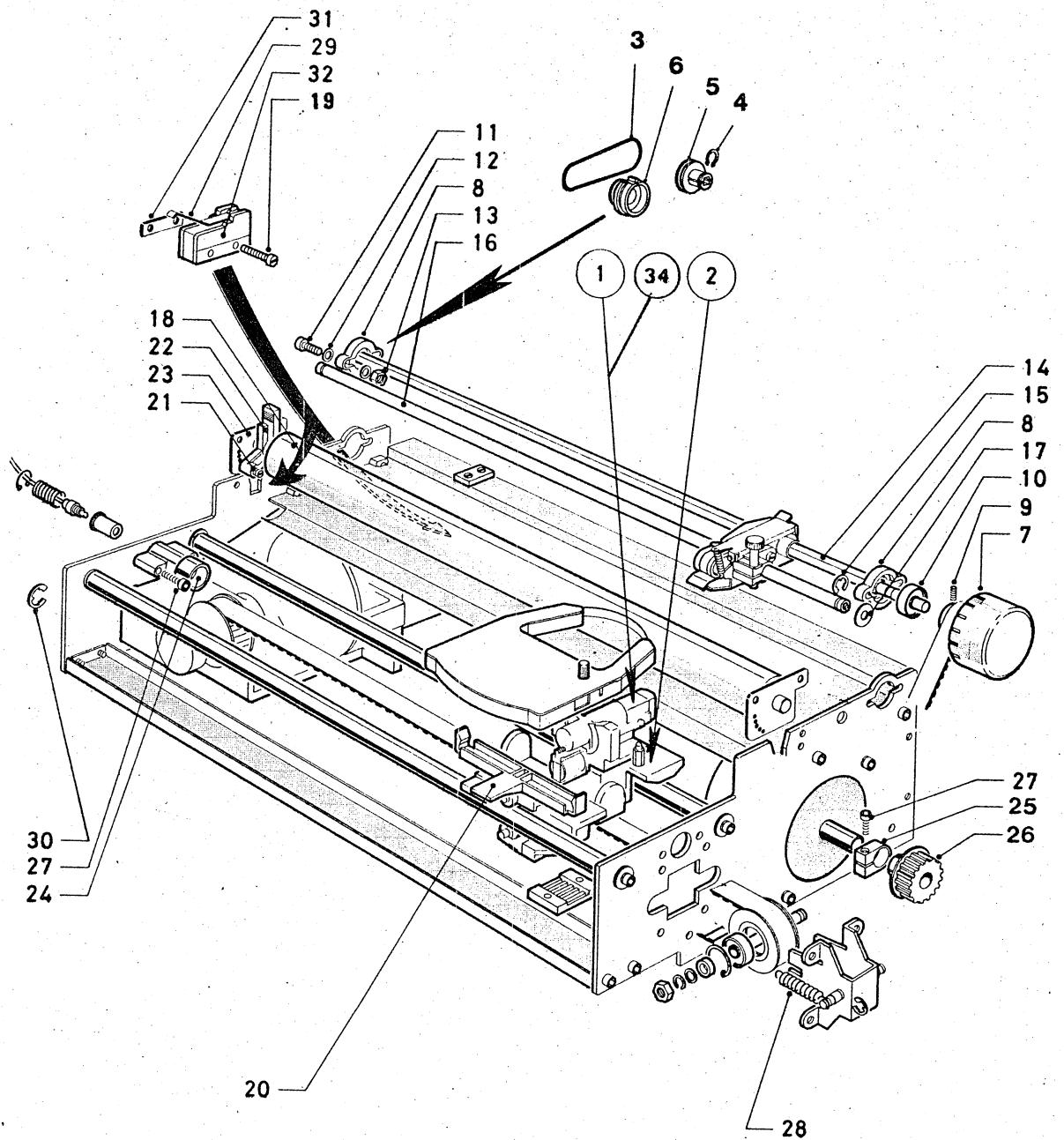
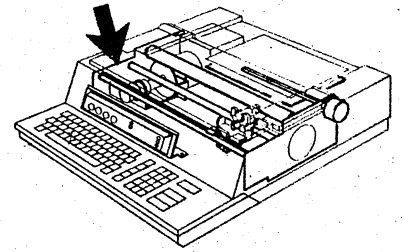
35	Micro Spring	78113527-001			
36	Retaining Ring	6337508R			
37	Bumper	78113529-001			
38	Micro Guide	78113530-001			
39	Micro Switch	78200212-001			
40	Head Cable	78114244-003			
41	Bearing	78203247-036			
42	Retaining Ring 19 dia	6337513Q			
43	Nut M6	6321206G			
44	Retaining Ring	6337111Y			
45	Wheel	78113495-001			
46	Spacer	78113494-001			
47	Pin	78113499-001			
48	Pulley Support	78113497-001			
49	Spring Holder	78113496-001			
50	Flat Washer	6331106F			
51	Spring Washer	6332106K			
52	Pulley Assy	78113812-001			
53	Motor Group	78114251-001			
54	Plate	78113551-001			
55	Motor Support Assembly	78118061-001		9.4	
56	Bumper Assembly	78113813-001			
57	Carriage Bars	78113520-001			
58	Belt	78203285-054			
59	Cartridge	78113904-002			
60	Left Tractor (metallic)	78115560-002			
61	Left Tractor (plastic)	78115935-002		Vedi Nota	
62	Right Tractor (metallic)	78115560-001		See Note	
63	Right Tractor (plastic)	78115935-001			
64	Knob	78115445-001			
65	Benzing	76951703-023			

Nota : Qualora in seguito ad una richiesta di un trattore metallico venga fornito il tipo in plastica, occorre sostituire sia il destro che il sinistro, pertanto il magazzino dovrà fornire la coppia.

Note : When a metallic tractor replacement is needed and the new plastic tractors only is available, it is necessary to replace left and both plastic tractors for functionality and appearance problems.



Figura 9-2 Assieme Meccanica - Figure 9-2 Mechanics Assembly

Tavola 9-3 Assieme Testina e Carrello - Table 9-3 Head and Carriage Assembly

INDEX No	DESCRIPTION	PART - NUMBER	USE ON CODE	REF. FIG.	MICRO-FICHE COORD.
	Head Assembly	78117381-002		9.3	
	Carriage Assembly	78113810-001		9.3	
1	Support	78115615-001			
2	Solenoid Assembly	78116019-001			
3	Screw M3 x 4	78203183-004			
4	Print Needle	78113389-003			
5	Print Needle Spring	78115619-001			
6	Ruby Holder	78116847-001			
7	Needles Cover	78115620-001			
8	Washer	76951134-490			
9	Plate	78113548-001			
10	Spring	78113534-001			
11	Tape Dragging Assembly	78117835-001			
12	Clamp	78113538-001			
13	Screw M2 x 6	6313056M			
14	Cartridge Pin	78113552-001			
15	Bearing Pin	78113816-001			
16	Motor	78114243-002			
17	Bearing Pin	78113549-001			
18	Bearing	78203247-303			
19	Retaining Ring	76951703-023			
20	Bearing Assembly	78115689-001			
21	Screw M3 x 8	76951108-501			

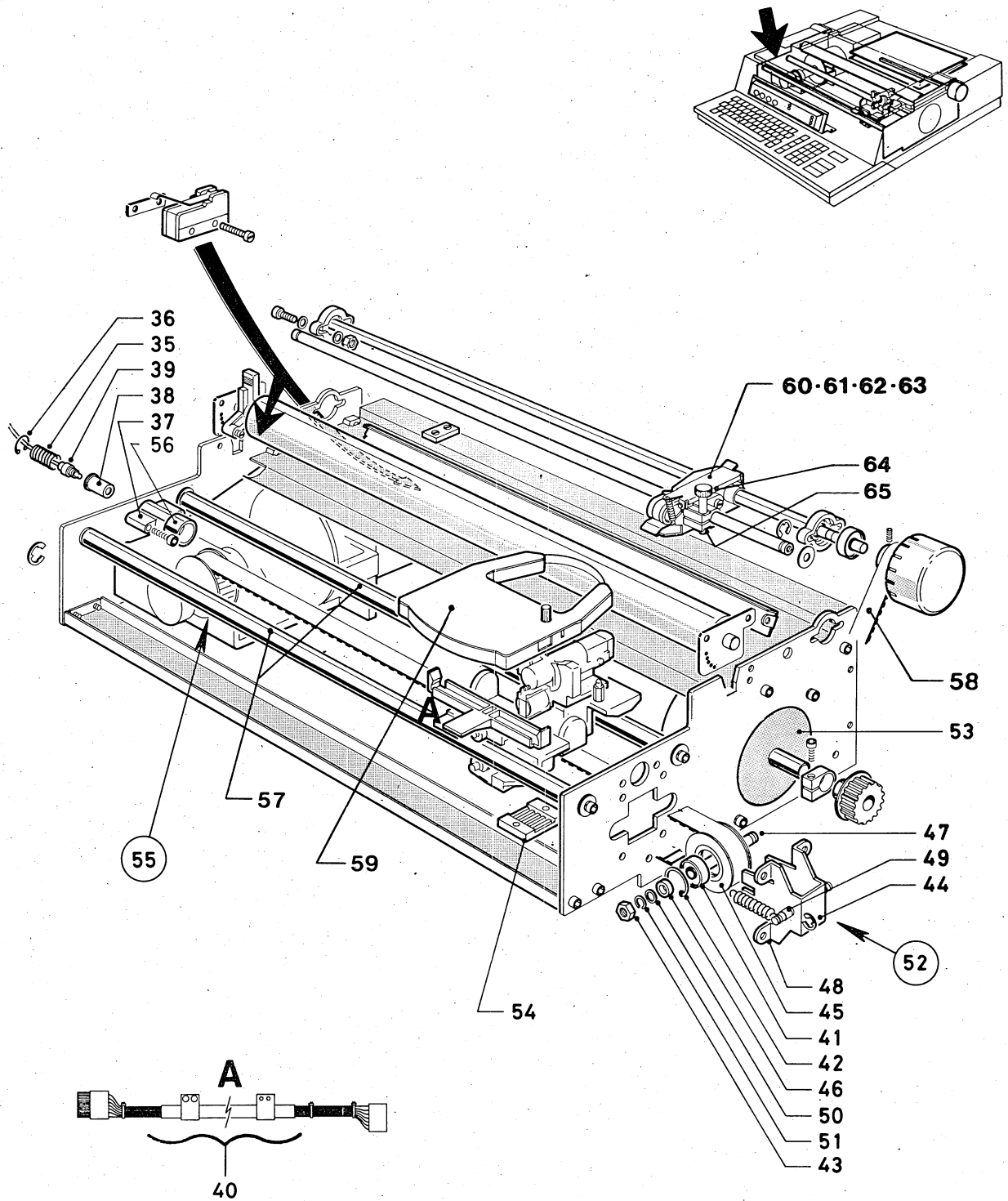

Figura 9-3 Assieme Testina e Carrello - Figure 9-3 Head and Carriage Assembly

Tavola 9 - 4 Assieme Supporto Motore - Table 9-4 Motor Holder Assy

INDEX No	DESCRIPTION	PART - NUMBER	USE ON CODE	REF. FIG.	MICRO-FICHE COORD.
	<u>Motor Holder Assembly (Old type)</u>	78113489-001		9.4	
1	Motor assy	78114251-001			
2	BELT	78203285-095			
3	Retaining ring	6337519A			
4	Bearing	78203247-510 (see note)			
5	Motor wheel	78113482-001 (see note)			
6	Motor shaft	78117343-001 (see note)			
7	Retaining ring	6337116D			
8	Retaining hub	78113484-001 (see note)			
9	Mistor GV3	5222023C			
10	Timing wheel	78113488-003 (see note)			
11	Mistor support	78113430-002			
12	Motor holder	78113429-001			
13	Flat washer	6331104X			
14	Spring washer	6332104B			
	<u>Motor Holder Assembly (New type)</u>	78118061-001		9.4.1	
1	Motor assy	78114251-001			
2	Belt	78203285-095			
3	Retaining ring	76951706-080			
4	Bearing 3/8	0001874X			
5	Motor wheel	78117340-001			
6	Retaining hub	78117047-001			
7	Retaining hub	78113484-001			
8	Mistor GV3	5222023C			
9	Motor shaft	78117343-001			
10	Motor Holder	78117339-002			
11	Timing wheel	78118062-001			
12	Transformation Kit	78118070-001 (see note)			

Note : I componenti del "vecchio gruppo motore" non vengono attualmente più prodotti. La sostituzione di questi componenti è considerata una operazione eccezionale in field; comunque qualora ciò si rendesse necessario, occorre ordinare il "Kit di trasformazione" 78118070-001 che può rimpiazzare i vecchi componenti secondo le indicazioni riportate nel capitolo MONTAGGI/SMONTAGGI della Sez. VIII.

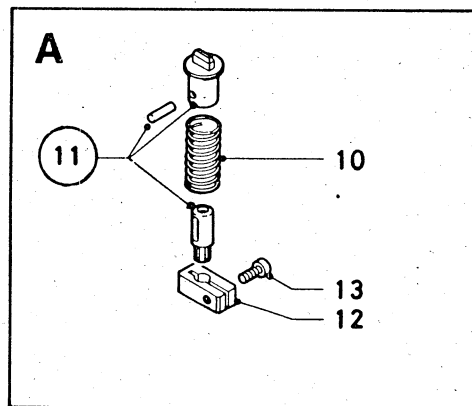
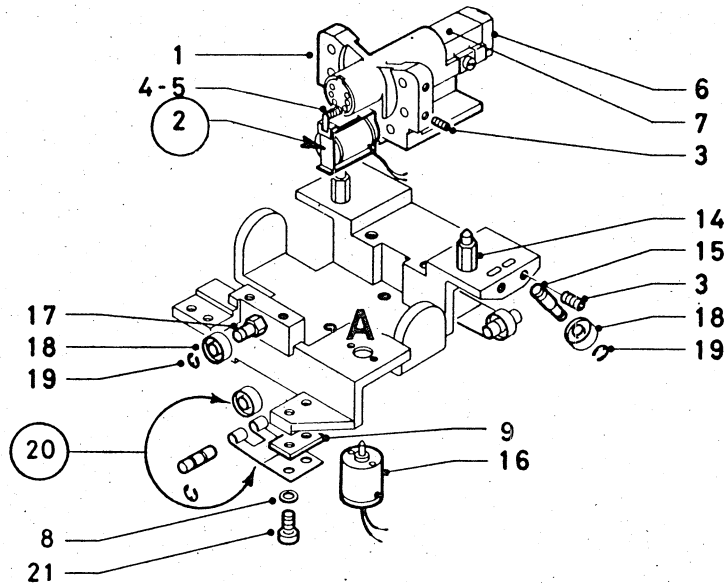
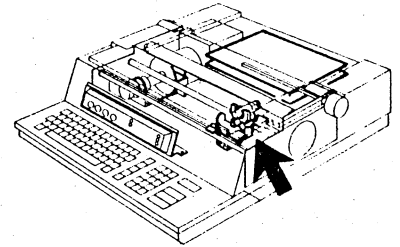
Notes: Some components of the old "Motor holder" p/n 78113489 are under exhaustion since replaced by the new currently manufactured. When is requested to replace these (unusual in field) is necessary order the "transformation kit" 78118070 that will replace the components of the old assy. The replacement procedure is content into the pertinent routine of section VIII, Maintenance.



Figura 9-4 Assieme Supporto Motore - Figure 9-4 Motor Holder Assembly

Tavola 9-5 Assieme Alimentatore - Table 9-5 Power Supply Assembly

INDEX No	DESCRIPTION	PART NUMBER	USE ON CODE	REF. FIG.	MICRO-FICHE COORD.
----------	-------------	-------------	-------------	-----------	--------------------

Bulk Assy

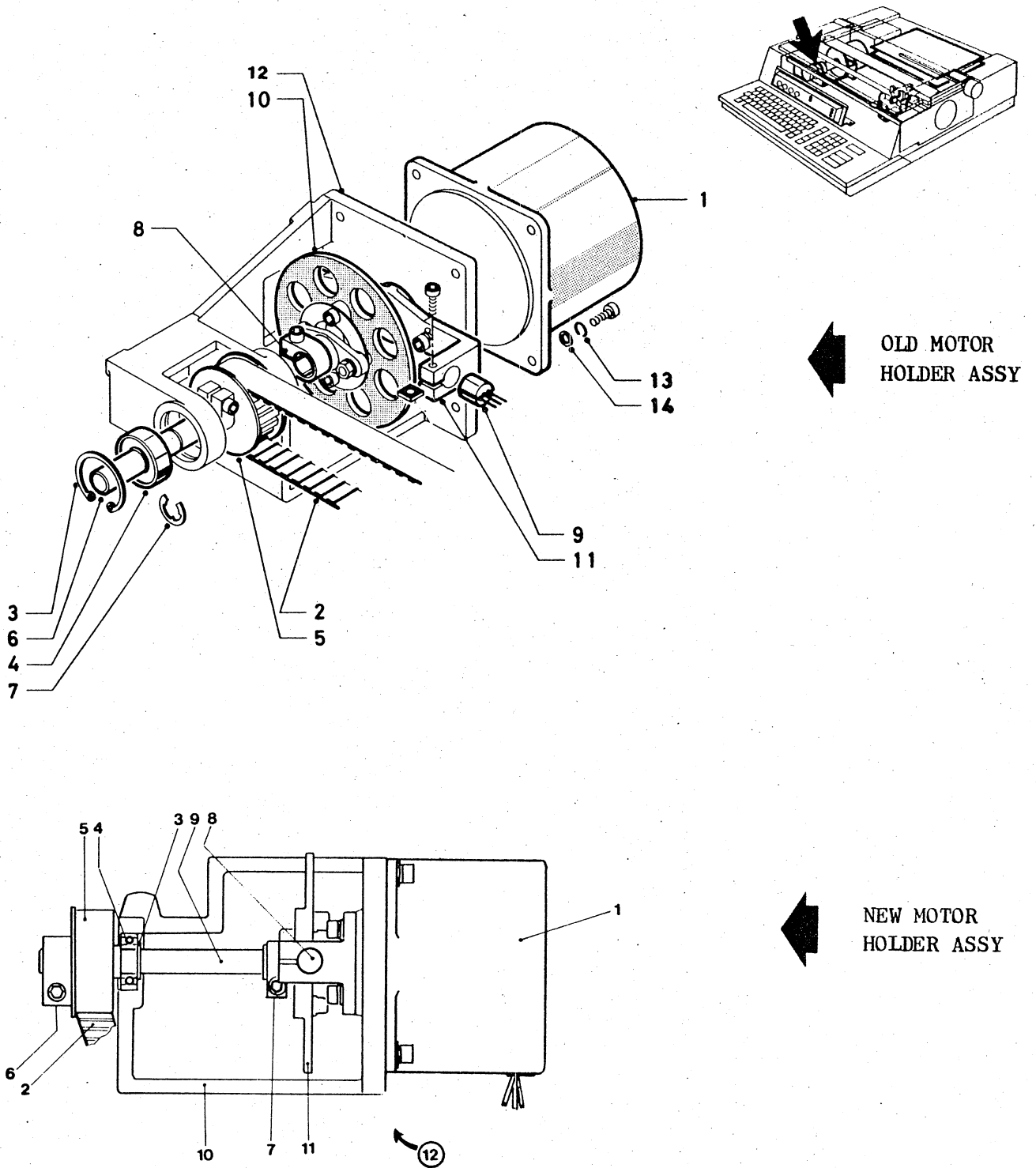
9.5

1	Capacitor 75.000 μ F 25V	78200160-135			
2	Capacitor 150.000 μ F 10V	78200160-210			
3	Capacitor 10 μ F 370V	78200158-001			
4	Capacitor 12.000 μ F 30V	78200160-140			
5	Resistor 6.8 12W	78200136-019			
6	Resistor 2 25W	78200135-007			
7	Transistor MJ3001	78200244-001			
8	Diode Bridge	78200320-002			
9	Transformer	78201097-001			
10	Buzzer	5883780M			
11	Fan	78200652-001			
12	Breaker 3A	78200225-001			
13	AC Hub	78201071-001			



Figura 9-5 Assieme Alimentatore - Table 9-5 Power Supply Assembly

Tavola 9-6 Pacco Logico - Table 9-6 Logic Boards

INDEX No	DESCRIPTION	PART-NUMBER	USE ON CODE	REF. FIG.	MICRO-FICHE COORD.
	Logic boards			9.6	
1	CPU Board (Without Eprom Chips)	78119300-001	} INTCH	9.7	
1	CPU Board (Without Eprom Chips)	78118450-005			
2	Drive Board	78117135-003			
3	AFF Board (Optional)	78117217-003			
4	AFF Eprom chip for ROSY 24A	78118276-002(6279)			
5	AFF Eprom chip for ROSY 24B	78119662-001(6482)			
6	AFF Eprom chip for ROSY 26	78119182-001(6314)			
7	AFF Eprom chip for POLY 21	78119388-001(6531)			
8	LOOCU Board (Optional)	78118448-001			
9	5° Chip F/W POLY 21 model	78119873-005(6530)			
10	Cables for CPU/DRIVE interconnec.	78201067-001			
11	AFFD Board (Optional to support the 5th POLY 21 F/W chip)	78119100-001			
12	CPO Board (Withou Eprom Chips) for LINA model	78119302-001		9-7.1	

Note:

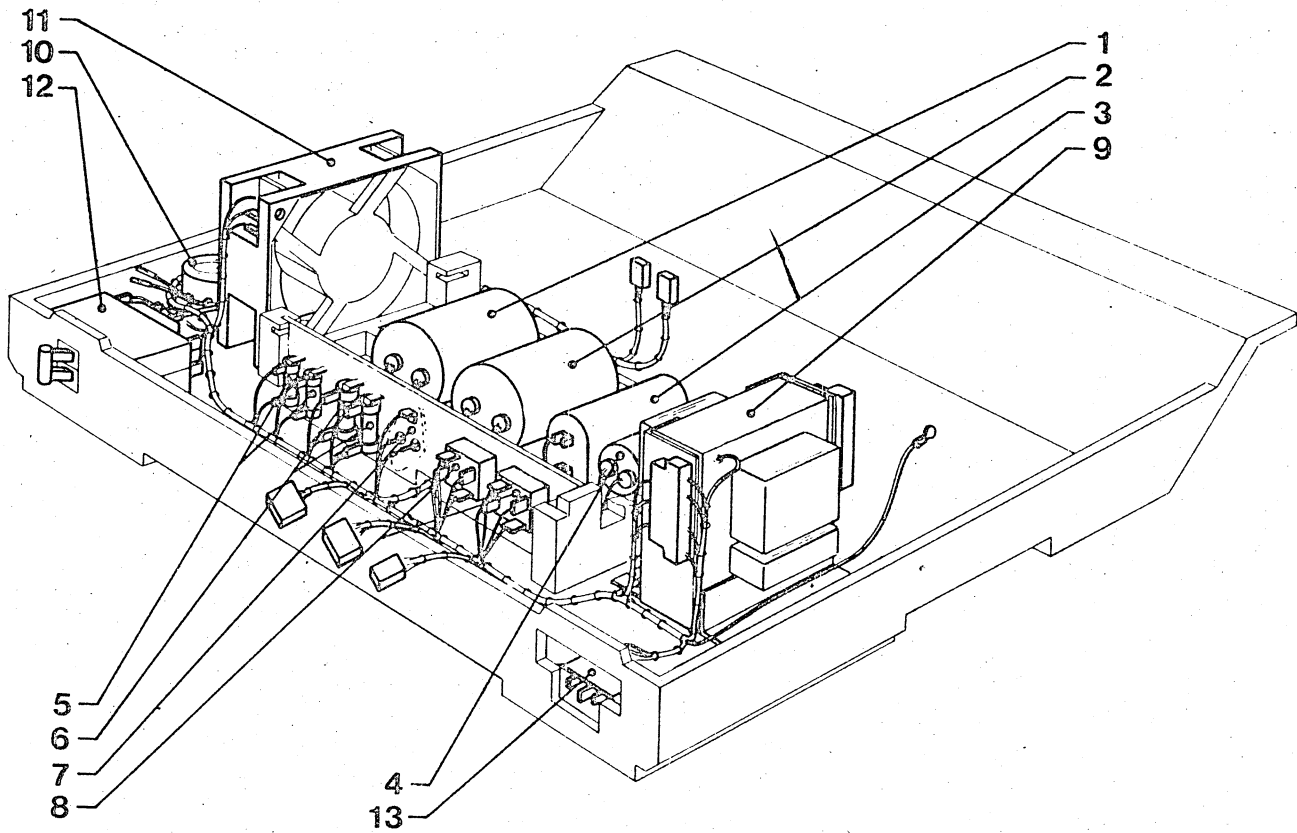
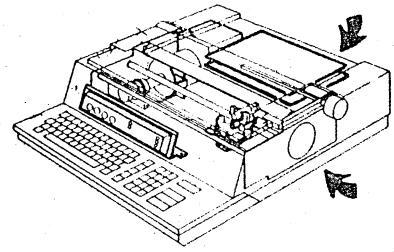
(xxxx) Il numero fra parentesi è un codice di riconoscimento che viene posto sul chip dalla fabbrica. Comunque sulla confezione del chip è indicato anche il codice ufficiale 8/3.

Note:

(xxxx) This number shows a reference mark applied by manufacturing directly on the chip. However on the chip envelope is pointed out also the official 8/3 part number.

Note:

- Le piastre CPU item 1 possono essere utilizzate su tutti i modelli LCSP (SARA/ROSY/POLY) eccetto per la LINA (stampante di linea). Qualora la piastra CPU vada a sostituire una CPU codice 78117136, occorre ordinare anche i n° 2 cavetti a posizione 10.
- La piastra DRIVE cod. 78117135-002 può essere ricevuta con una nota di installazione da seguire prima della sostituzione.

Note:

- The boards CPU item 1 can be installed on all LCSP models (SARA/ROSY/POLY) exception mode for LINA model (output printer). When the CPU board go to replace the CPU board P/N 78117136, it is necessary to order also two cable item 10.
- The board DRIVE cod. 78117135-002 may-be sent with installation instruction to be checked before the board replacement.



Figura 9-6 Pacco Logico - Figure 9-6 Logic Boards

Tavola 9-7 Chips della piastra CPU - Table 9-7 CPU Board Chips

INDEX No	DESCRIPTION	PART-NUMBER	USE ON CODE	REF. FIG.	MICRO-FICHE COORD.
	CPU Board "EPROM" chips (Terminals and Console Printers)			9.7	
1	1° Chip F/W SARA model	78117623-007(6363)			
2	1° Chip F/W ROSY 24A model	78118274-004(6274)			
3	1° Chip F/W ROSY 24B model	78119657-001(6478)			
4	1° Chip F/W ROSY 26 model	78118952-001(6221)			
5	1° Chip F/W POLY 21 model	78119873-001(6526)			
6	2° Chip F/W SARA model	78117623-008(6364)			
7	2° Chip F/W ROSY 24A model	78118274-005(6275)			
8	2° Chip F/W ROSY 24B model	78119657-002(6479)			
9	2° Chip F/W ROSY 26 model	78118952-002(6222)			
10	2° Chip F/W POLY 21 model	78119873-002(6527)			
11	3° Chip F/W SARA model	78117623-009(6365)			
12	3° Chip F/W ROSY 24A model	78118274-006(6276)			
13	3° Chip F/W ROSY 24B model	78119657-003(6480)			
14	3° Chip F/W ROSY 26 model	78118952-003(6223)			
15	3° Chip F/W POLY 21 model	78119873-003(6528)			
16	4° Chip F/W ROSY 24B model	78114657-004(6481)			
17	4° Chip F/W ROSY 26 model	78118952-004(6224)			
18	4° Chip F/W POLY 21 model	78119873-004(6529)			
19	5° Chip F/W POLY 21 model	78119873-005(6530)		9.6	
20	Character set NPL for SARA Mod.	78117638-003(6368)			
21	Character set NML U. and L. Case for SARA model	78117634-003(6366)			
22	Character set NML U.C. for SARA model	78117768-003(6367)			
23	Character set INT'L U.C. for ROSY 24A model	78118275-002(6278)			
24	Character set INT'L U. and L. for ROSY 24A model	78118319-002(6277)			
25	Character set INT'L U. and L. for ROSY 24B model	78119667-001(6483)			
26	Character set INT'L U.C. for ROSY 26 model	78118954-001(6225)			
27	Character set INT'L U. and L. for ROSY 26 model	78118956-001(6226)			
28	Character set INT'L U. and L. for POLY 21 model	78119907-001(6525)			

Nota:

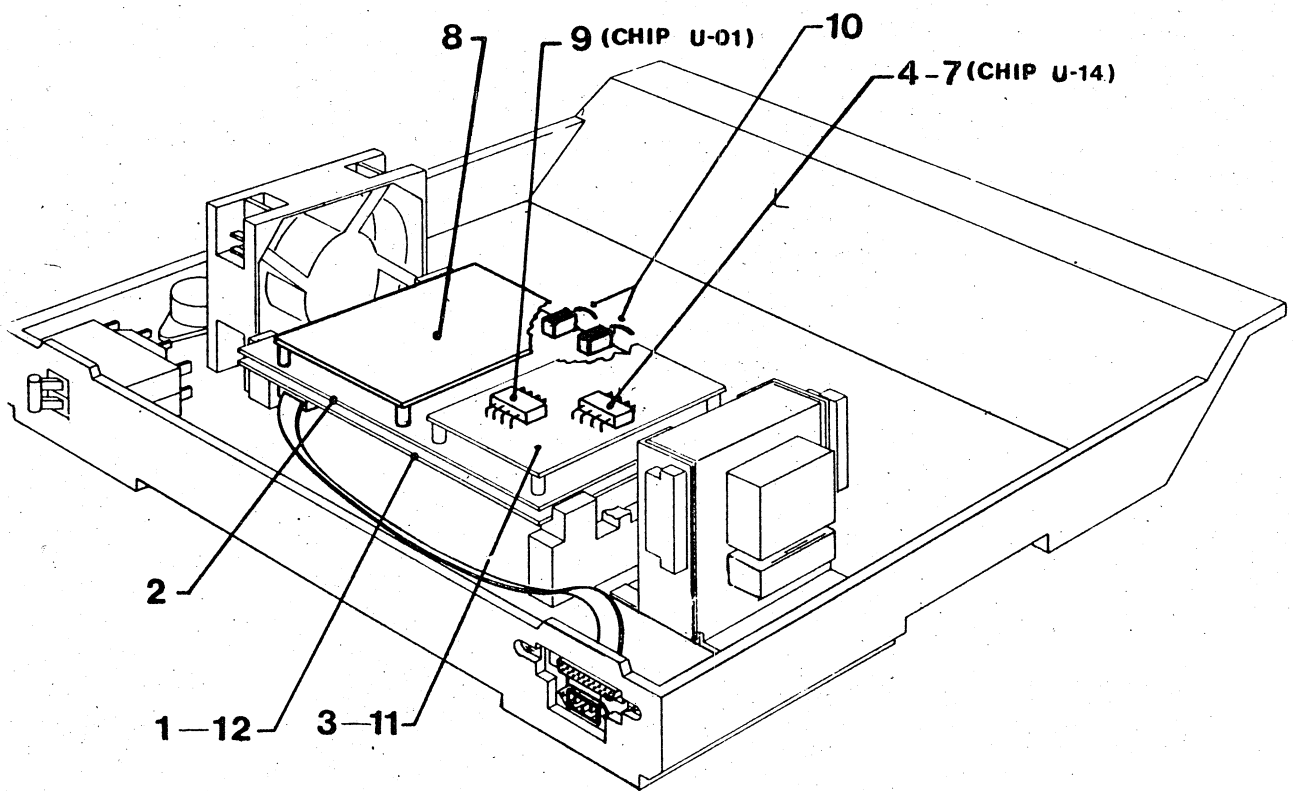
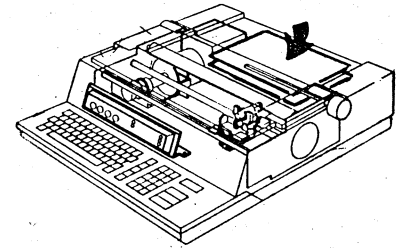
(xxxx) Il numero fra parentesi è un codice di riconoscimento che viene posto sul chip dalla fabbrica. Comunque sulla confezione del chip è indicato anche il codice ufficiale 8/3.

Note:

(xxxx) This number shows a reference mark applied by manufacturing directly on the chip. However on the chip envelope is pointed out also the official 8/3 part number.



Figura 9-7 Chip della piastra CPU - Figure 9-7 CPU Board Chip

Tavola 9 - 7 Chips della piastra CPU - Table 9 - 7 CPU board Chips

INDEX No	DESCRIPTION	PART-NUMBER	USE ON CODE	REF. FIG.	MICRO-FICHE COORD.
----------	-------------	-------------	-------------	-----------	--------------------

29	Character set FRA/BELG. U/L.C. for ROSY26 model	78119401-001(6419)			
30	Character set UK U/L.C. for ROSY26 model	78119402-001(6420)			
31	Character set DAN/NORW. U/L.C. for ROSY26 model	78119403-001(6421)			
32	Character set SWE/FINL. U/L.C. for ROSY26 model	78119404-001(6422)			
33	Character set SPA/MEX U/L.C. for ROSY26 model	78119405-001(6423)			
34	Character set GER/AUST. U/L.C. for ROSY26 model	78119406-001(6424)			
35	Character set PORT/BRA U/L.C. for ROSY26 model	78119407-001(6425)			
36	RAM (Memory)chip (U01-U10)	78200414-001			

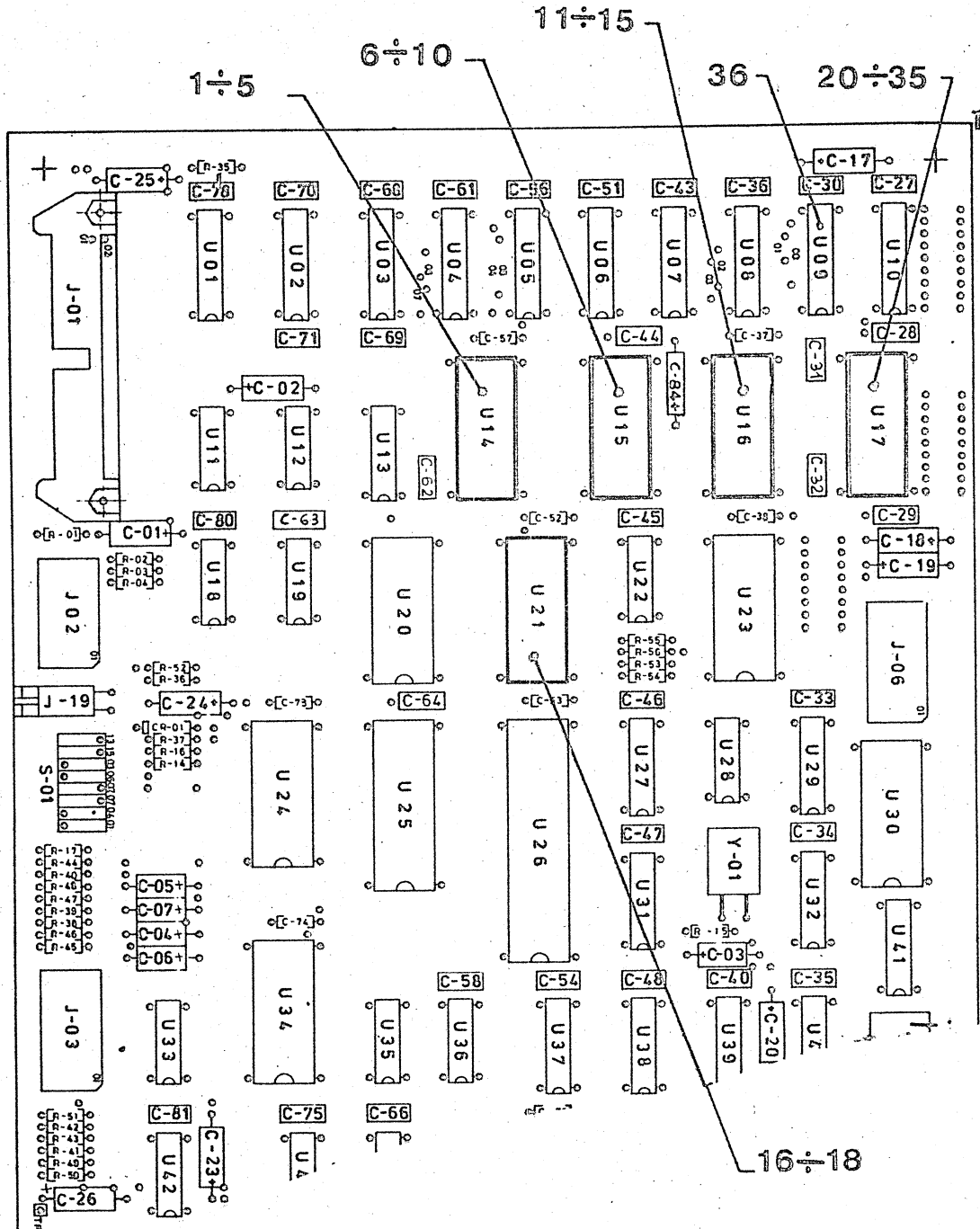
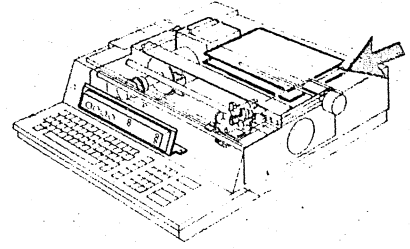
Nota:

(xxxx) Il numero fra parentesi è un codice di riconoscimento che viene posto sul chip dalla fabbrica. Comunque sulla confezione del chip è indicato anche il codice ufficiale 8/3

Note:

(xxxx) This number shows a reference mark applied by manufacturing directly on the chip. However on the chip envelope is pointed out also the official 8/3 part number.



Figura 9-7 Chip della piastra CPU - Figure 9-7 CPU Board Chip

Tavola 9-7.1 Chips della piastra CPO -- Table 9-7.1 CPO Board Chips

INDEX No	DESCRIPTION	PART-NUMBER	USE ON CODE	REF. FIG.	MICRO-FICHE COORD.
----------	-------------	-------------	-------------	-----------	--------------------

CPO Board "EPROM" Chips (output printer)

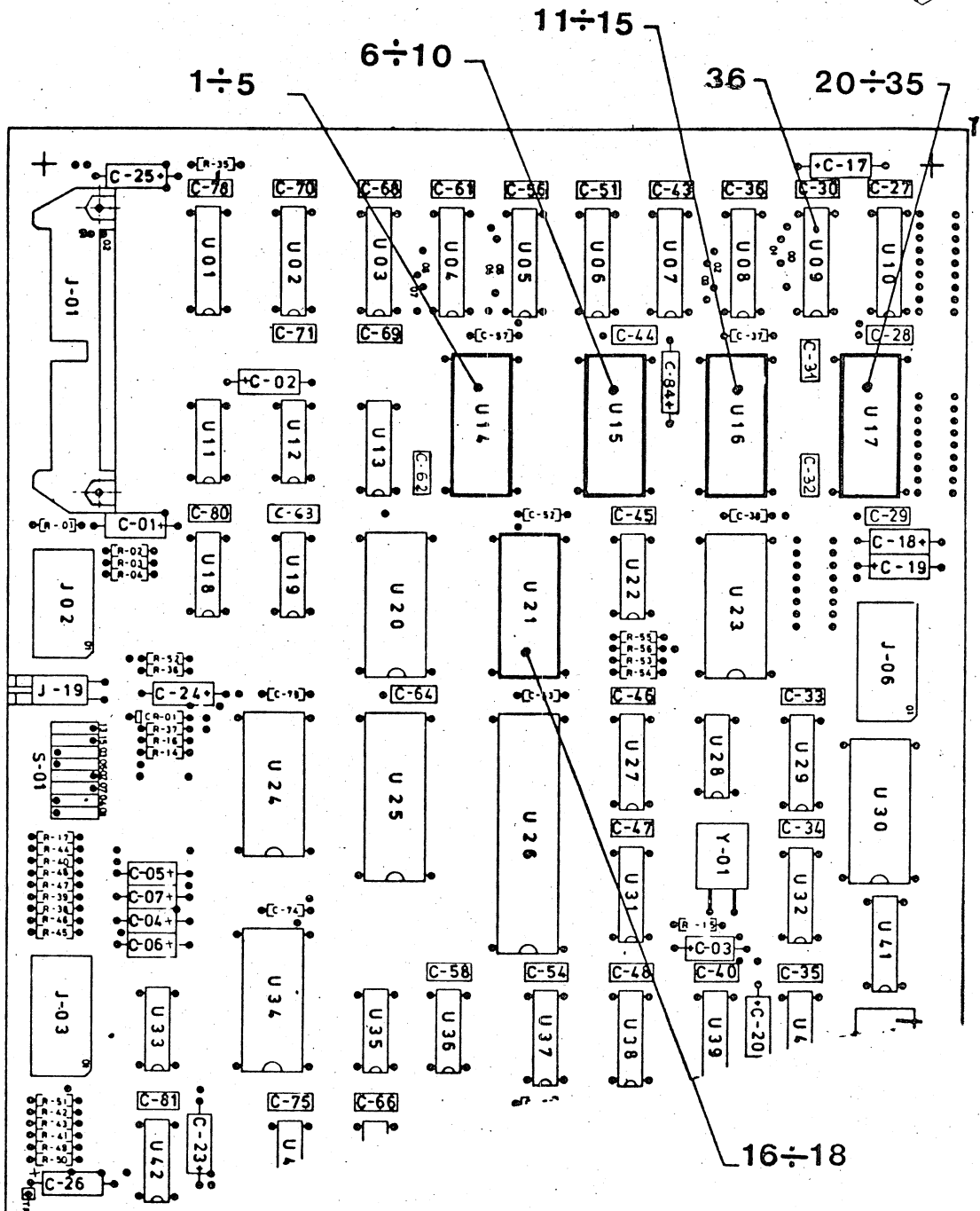
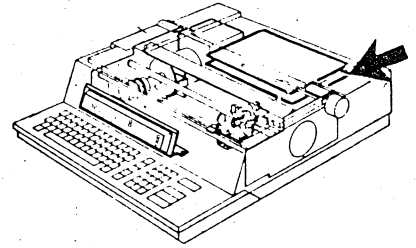
9-7.1

1	1° Chip F/W LINA 21 model	78119632-001 (6462)			
2	2° Chip F/W LINA 21 model	78119632-002 (6463)			
3	3° Chip F/W LINA 21 model	78119632-003 (6464)			
4	Character set INT'L U. and L. Case for LINA 21 model	78119634-001 (6465)			

Nota:

(xxxx) Il numero fra parentesi è un codice di riconoscimento che viene posto sul chip dalla fabbrica. Comunque sulla confezione del chip è indicato anche il codice ufficiale 8/3.

Note: This number shows a reference mark applied by manufacturing directly on (xxxx) the chip. However on the chip envelope is pointed out also the official 8/3 part number.

Tavola 9-8 Coperture e Tastiera - Table 9-8 Covers and Keyboard Group

INDEX No	DESCRIPTION	PART-NUMBER	USE ON CODE	REF. FIG.	MICRO-FICHE COORD.
----------	-------------	-------------	-------------	-----------	--------------------

Covers and Keyboard Group

9.8

1	Cover	78115365-001			
2	Right Panel	78115366-001			
3	Left Panel	78115367-001			
4	Front Panel	78115368-001			
5	Paper Slide Plate	78115031-001			
6	Cover	78115364-001			
8	Single Module SDII	78114628-061			
9	Single Module SWII	4377386C			
10	Module	4377384U			
11	"LOCK" Module	4377385Y			
12	Keyboard Group	78115204-002			
13	Keyboard Assy 76SWII-2 (L62 Console)	5141780S			
14	Keyboard Assy 60SDII-2 (ROSY 24/26)	5141781T			
15	Keyboard Assy 60SDII-3 (SARA 20)	5141775K			
16	Keyboard Assy 86SWII (POLY 21)	5141795V			



Figura 9-8 Coperture e Testiera - Figure 9-8 Covers and Keyboard Group

Revisione - Revision 0 / Marzo - March 1977

Tavola 9-9 Pannello Operatore - Table 9-9 Operator

INDEX No	DESCRIPTION	PART - NUMBER	USE ON CODE	REF. FIG.	MICRO-FICHE COORD.
----------	-------------	---------------	-------------	-----------	--------------------

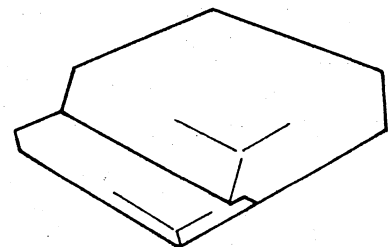
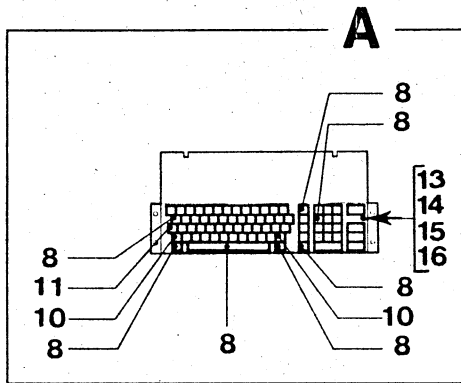
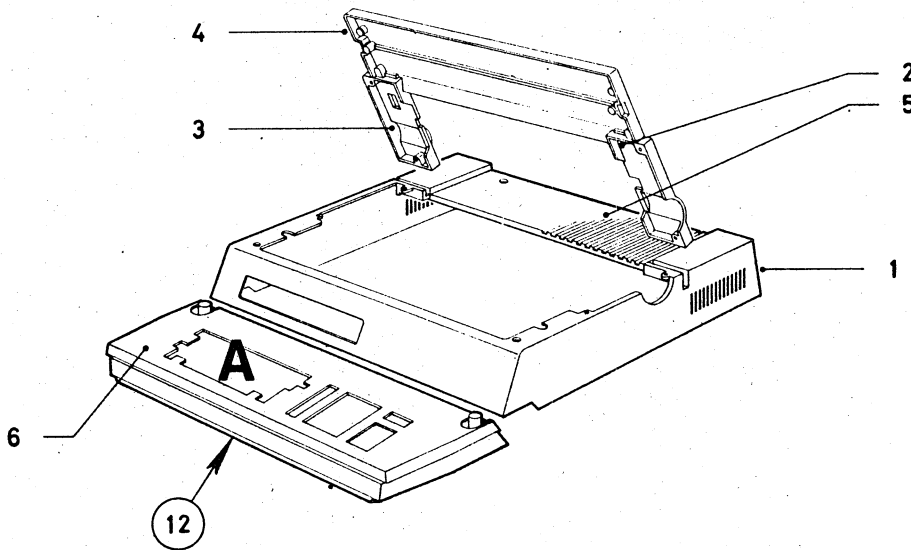
Operator Panel

9.9

1	Pushbutton	78200195-001			
2	Led	78200403-001			
3	Deviator	78200215-002			
4	Display (Optional)	78117616-002			



Figura 9-9 Pannello Operatore - Figure 9-9 Operator Panel

Revisione - Revision 0 / Marzo - March 1977

Tavola 9-10 Opzione AFF (Meccanica) - Table 9-10 Opt. AFF (Mechanism)

INDEX No	DESCRIPTION	PART-NUMBER	USE ON CODE	REF. FIG.	MICRO-FICHE COORD.
----------	-------------	-------------	-------------	-----------	--------------------

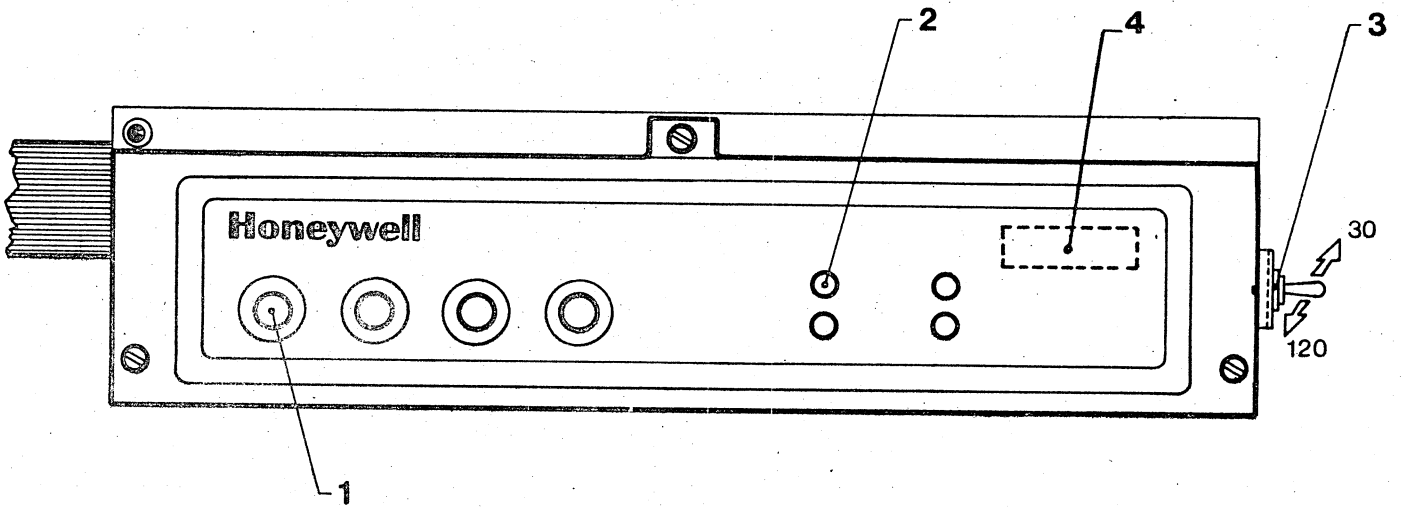
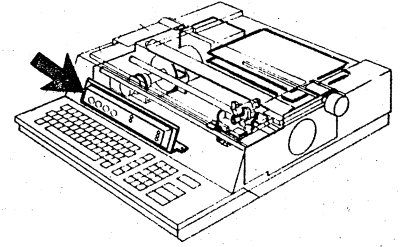
AFF Option				9.10	
1	AFF Assembly	78117558-001			
2	Push button	78200219-005			
3	Guide Assy	78117551-001			
4	Detector	78117568-001			
5	Rolley Clutch	78117555-001			
6	Positioning Clutch	78117556-001			
7	Spring	78117539-001			
8	Belt	78203284-033			
9	Motor Pulley Assy	78117549-001			
10	Aff board	See / Vedere		9.6	



Figura 9-10 Opzione AFF (Meccanica) - Figure 9-10 Opt. AFF (Mechanism)

Tavola 9-11 Opzione VFU

-

Table 9-11 Opt VFU

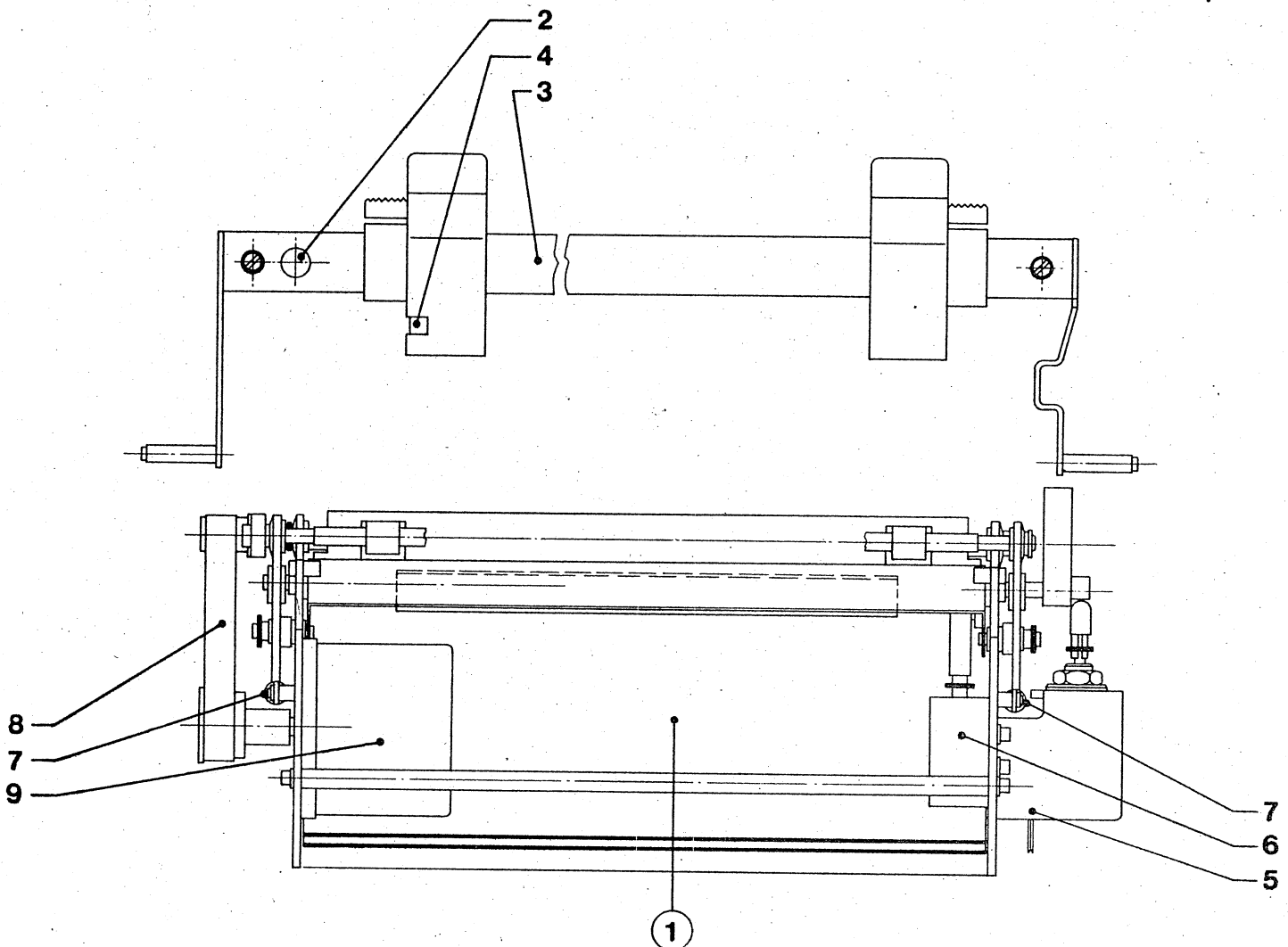
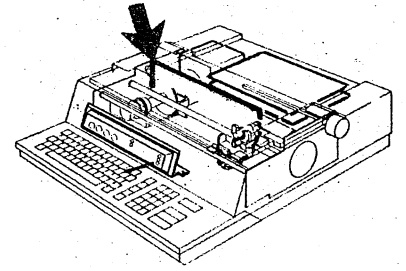
INDEX No	DESCRIPTION	PART - NUMBER	USE ON CODE	REF. FIG.	MICRO-FICHE COORD.
----------	-------------	---------------	-------------	-----------	--------------------

VFU option

9.11

1	VFU Assembly	78117766-001			
2	Motor	78114628-130			
3	Lamp	78114628-128			
4	Light guide	78114628-129			
5	VFU board	78117219-002			



Figura 9-11 Opzione VFU

- Table 9-11 Opt VFU

REPERTORIO NUMERICO - NUMERICAL PART LIST

CODICE PART NUMBER	COORD.	PAG. PAGE	RIF. REF.	CODICE PART NUMBER	COORD.	PAG. PAGE	RIF. REF.
0001874X	A12	12	4	78113499-001	A08	8	47
0005041C	A06	6	9	78113511-001	A06	6	23
4377384U	B11	20	10	78113389-003	A10	10	4
4377385Y	B11	20	11	78113429-001	A12	12	12
4377386C	B11	20	9	78113430-002	A12	12	11
5141775K	B11	20	15	78113512-001	A06	6	22
5141780S	B11	20	13	78113516-001	A06	6	16
5141781T	B11	20	14	78113517-001	A06	6	26
5141795V	B11	20	16	78113520-001	A08	8	57
5222023C	A12	12	8	78113521-001	A06	6	8
5222023C	A12	12	9	78113527-001	A08	8	35
5883780M	P01	14	10	78113528-001	A06	6	24
6313056M	A10	10	13	78113529-001	A08	8	37
6313104X	A06	6	12	78113530-001	A08	8	38
6313117E	A06	6	11	78113534-001	A10	10	10
6313118T	A06	6	27	78113538-001	A10	10	12
6321104W	A06	6	13	78113548-001	A10	10	9
6321206G	A08	8	43	78113549-001	A10	10	17
6331104X	A12	12	13	78113551-001	A08	8	54
6331106F	A08	8	50	78113552-001	A10	10	14
6332104B	A12	12	14	78113553-001	A06	6	17
6332106K	A08	8	51	78113810-001	A06	6	2
6337111Y	A08	8	44	78113810-001	A10	10	AG
6337112C	A06	6	15	78113812-001	A08	8	52
6337116D	A12	12	7	78113813-001	A08	8	56
6337118W	A06	6	30	78113816-001	A10	10	15
6337309H	A06	6	4	78113820-001	A06	6	20
6337508R	A08	8	36	78113904-002	A08	8	59
6337513Q	A08	8	42	78114243-002	A10	10	16
6337519A	A12	12	3	78114244-003	A08	8	40
7454693W	A06	6	19	78114251-001	A08	8	53
76951108-501	A10	10	21	78114251-001	A12	12	1
76951134-490	A10	10	8	78114251-001	A12	12	1
76951703-023	A08	8	65	78114555-001	A06	6	7
76951703-023	A10	10	19	78114628-061	B11	20	8
76951706-080	A12	12	3	78114628-128	C03	26	3
78105720-001	A06	6	31	78114628-129	C03	26	4
78113482-001	A12	12	5	78114628-130	C03	26	2
78113484-001	A06	6	25	78115031-001	B11	20	5
78113484-001	A12	12	7	78115070-001	A06	6	6
78113484-001	A12	12	8	78115071-001	A06	6	5
78113488-003	A12	12	10	78115204-002	B11	20	12
78113489-001	A12	12	AG	78115238-001	A06	6	18
78113494-001	A08	8	46	78115364-001	B11	20	6
78113495-001	A08	8	45	78115365-001	B11	20	1
78113496-001	A08	8	49	78115366-001	B11	20	2
78113497-001	A08	8	48	78115367-001	B11	20	3
78113498-002	A06	6	28	78115368-001	B11	20	4

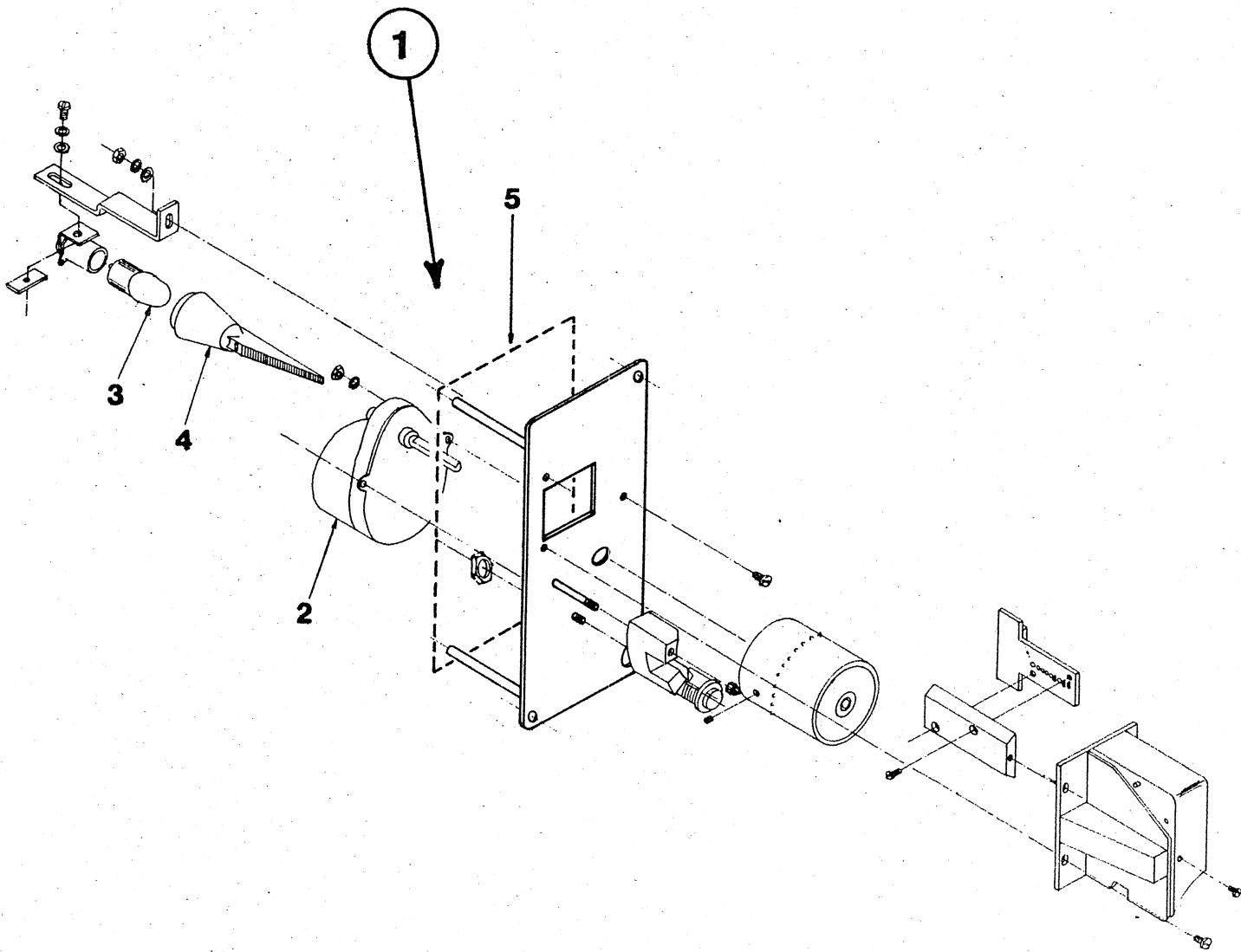
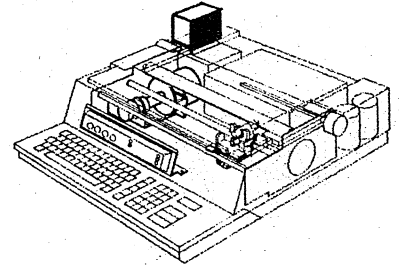
REPERTORIO NUMERICO - NUMERICAL PART LIST

CODICE PART NUMBER	COORD.	PAG. PAGE	RIF. REF.	CODICE PART NUMBER	COORD.	PAG. PAGE	RIF. REF.
78115442-001	A06	6	29	78118319-002	B05	18	24
78115445-001	A08	8	64	78118448-001	B03	16	8
78115560-001	A08	8	62	78118450-005	B03	16	1
78115560-002	A08	8	60	78118952-001	B05	18	4
78115615-001	A10	10	1	78118952-002	B05	18	9
78115619-001	A10	10	5	78118952-003	B05	18	14
78115620-001	A10	10	7	78118952-004	B05	18	17
78115689-001	A10	10	20	78118954-001	B05	18	26
78115935-001	A08	8	63	78118956-001	B05	18	27
78115935-002	A08	8	61	78119873-001	B05	18	5
78116019-001	A10	10	2	78119873-002	B05	18	10
78116847-001	A10	10	6	78119873-003	B05	18	15
78117047-001	A12	12	6	78119873-004	B05	18	18
78117117-001	A06	6	14	78119873-005	B03	16	9
78117135-002	B03	16	2	78119873-005	B05	18	19
78117217-003	B03	16	3	78119907-001	B05	18	28
78117219-002	C03	26	5	78119100-001	B03	16	11
78117339-002	A12	12	10	78119182-001	B03	16	6
78117340-001	A12	12	5	78119300-001	B03	16	1
78117343-001	A12	12	6	78119302-001	B03	16	12
78117343-001	A12	12	9	78119388-001	B03	16	7
78117381-002	A06	6	1	78119401-001	B07	19.1	29
78117381-002	A10	10	AG	78119402-001	B07	19.1	30
78117539-001	C01	24	7	78119403-001	B07	19.1	31
78117549-001	C01	24	9	78119404-001	B07	19.1	32
78117551-001	C01	24	3	78119405-001	B07	19.1	33
78117555-001	C01	24	5	78119406-001	B07	19.1	34
78117556-001	C01	24	6	78119407-001	B07	19.1	35
78117558-001	C01	24	1	78119662-001	B03	16	5
78117568-001	C01	24	4	78119657-001	B05	18	3
78117616-002	B13	22	4	78119667-001	B05	18	25
78117623-007	B05	18	1	78119657-004	B05	18	16
78117623-008	B05	18	6	78119657-002	B05	18	8
78117623-009	B05	18	11	78119657-003	B05	18	13
78117634-003	B05	18	21	78119632-001	B09	19.3	1
78117638-003	B05	18	20	78119632-002	B09	19.3	2
78117766-001	C03	26	1	78119632-003	B09	19.3	3
78117768-003	B05	18	22	78119634-001	B09	19.3	4
78117835-001	A10	10	11	78200135-007	B01	14	6
78118061-001	A08	8	55	78200136-019	B01	14	5
78118061-001	A12	12	AG	78200158-001	B01	14	3
78118062-001	A12	12	11				
78118070-001	A12	12	12				
78118274-004	B05	18	2				
78118274-005	B05	18	7				
78118274-006	B05	18	12				
78118275-002	B05	18	23				
78118276-002	B03	16	4				

REPERTORIO NUMERICO - NUMERICAL PART LIST

CODICE PART NUMBER	COORD.	PAG. PAGE	RIF. REF.	CODICE PART NUMBER	COORD.	PAG. PAGE	RIF. REF.
78200160-135	B01	14	1				
78200160-140	B01	14	4				
78200160-210	B01	14	2				
78200192-002	A06	6	32				
78200195-001	B13	22	1				
78200212-001	A08	8	39				
78200215-002	B13	22	3				
78200219-005	C01	24	2				
78200225-001	B01	14	12				
78200244-001	B01	14	7				
78200320-002	B01	14	8				
78200403-001	B13	22	2				
78200414-001	B07	19.1	36				
78200652-001	B01	14	11				
78201067-001	B03	16	10				
78201071-001	B01	14	13				
78201097-001	B01	14	9				
78203153-001	A06	6	3				
78203182-001	A06	6	21				
78203183-004	A10	10	3				
78203247-036	A06	6	10				
78203247-036	A08	8	41				
78203247-303	A10	10	18				
78203247-510	A12	12	4				
78203284-033	C01	24	8				
78203285-054	A08	8	58				
78203285-095	A12	12	2				
78203285-095	A12	12	2				

